

NOTE: DO NOT DISCARD the Parts List from the Instruction Bulletin. Place the Parts List in the appropriate place in the machine manual for future reference. Retaining the Parts List will make it easier to reorder individual parts and will save the cost of ordering an entire kit.

NOTE: Numbers in parenthesis () are reference numbers for parts listed in Bill of Materials.

Installation instructions for **kit number 9001717**

SYNOPSIS:

This kit contains the parts needed to install an OHG revolving light kit on M20/T20 machines. Please follow step-by-step instructions.

SPECIAL TOOLS / CONSIDERATIONS: NONE

(Estimated time to complete: 1 hour)

PREPARATION:

1. Park the machine on a clean level surface, turn off the machine, remove the key, and set the parking brake.

FOR SAFETY: Before leaving or servicing machine, stop on level surface, set parking brake, turn off machine, and remove key.

2. Open the front shroud and the engine shroud.
3. Disconnect the negative battery cable from the battery.



WARNING: Always disconnect battery cables from machine before working on electrical components.

INSTALLATION:

1. Pull the insulation away from the operator compartment panel (Fig. 1.) and drill a 13/16" hole into the panel (Fig. 2). If there is already a hole in the panel, remove the plug from the hole.

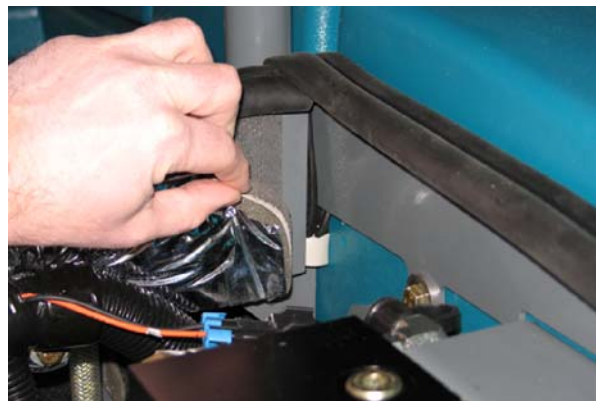

FIG. 1

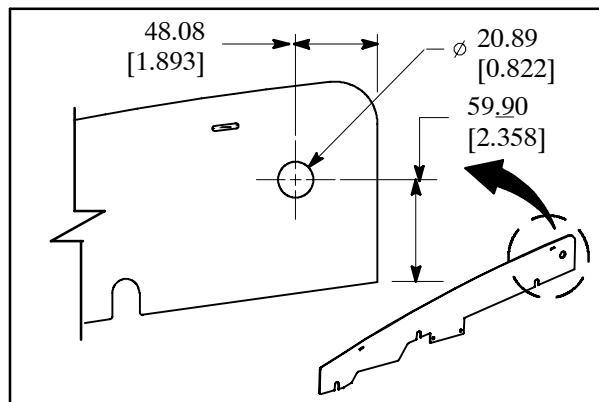

FIG. 2

2. Insert a grommet (6) into the hole in the operator compartment panel (Fig. 3) and the hole on top the overhead guard (Fig. 4).

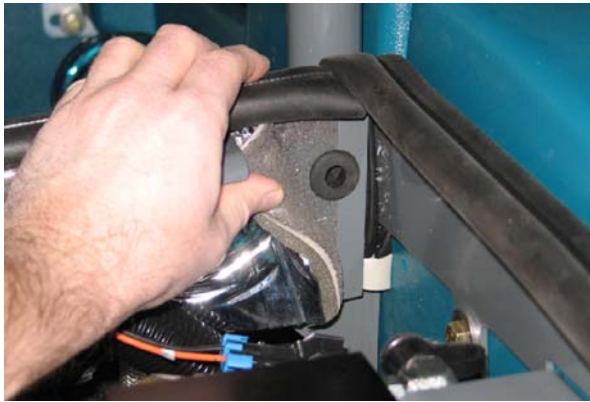

FIG. 3

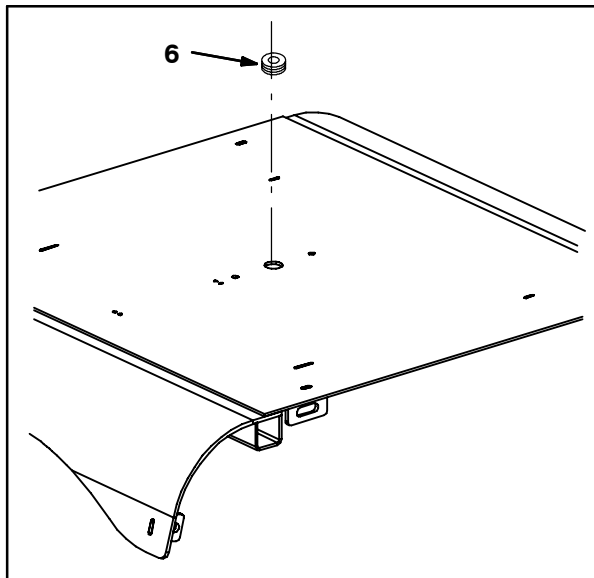

FIG. 4

3. Route the wires from the light (1) down through the grommet (6) installed in the overhead guard and use two hex screws (2), flat washers (3), and hex nuts (4) to install the light onto the overhead guard. (Fig. 5)

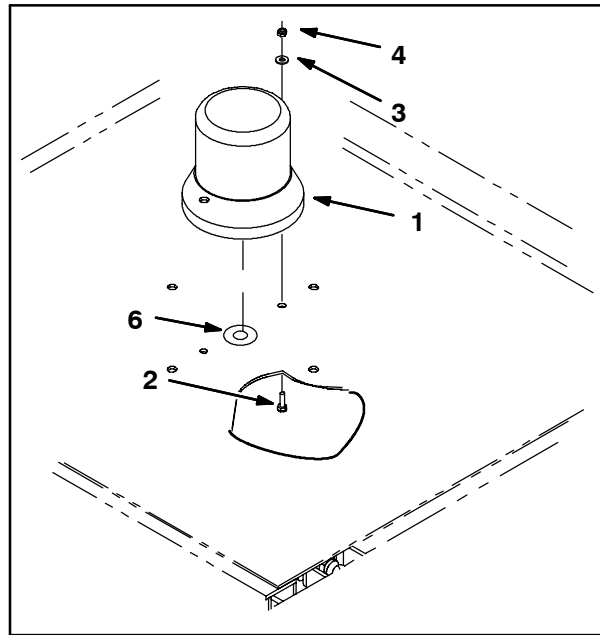

FIG. 5

4. Connect the warning/overhead harness (5) to the main wire harness, route the warning/overhead harness through the grommet installed in the operator compartment panel, up along leg of the overhead guard, and to the rear cross member of the overhead guard. (Fig. 10 and Fig. 11)

5. Insert a grommet (6) into the rear hole in the rear cross member of the overhead guard and route the warning/overhead harness (5) through the grommet and the front hole in the rear cross member. (Fig. 6)

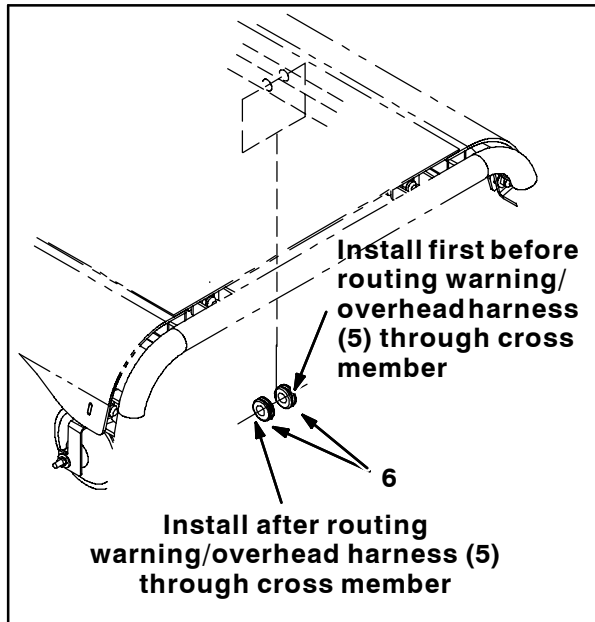

FIG. 6

6. Slide the remaining grommet (6) onto the warning/overhead harness (5) and insert the grommet into the front hole in the rear cross member of the overhead guard. (Fig. 6)
7. Route the warning/OHG harness (5) through the notch in the overhead guard insulation and connect the warning/OHG harness to the light (1). (Fig. 7 and Fig. 11)

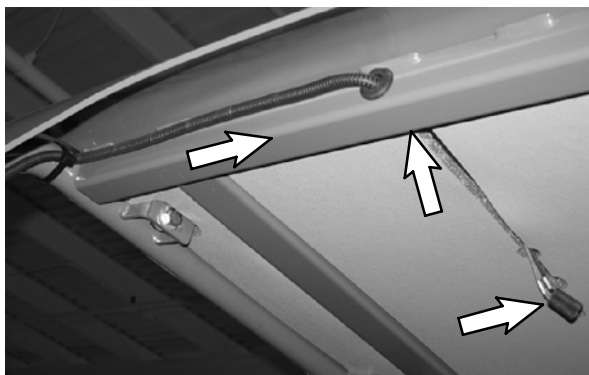

FIG. 7

8. Use four cable ties (7) to secure the warning/overhead harness (5) to the leg of the overhead guard. (Fig. 8 and Fig. 9)

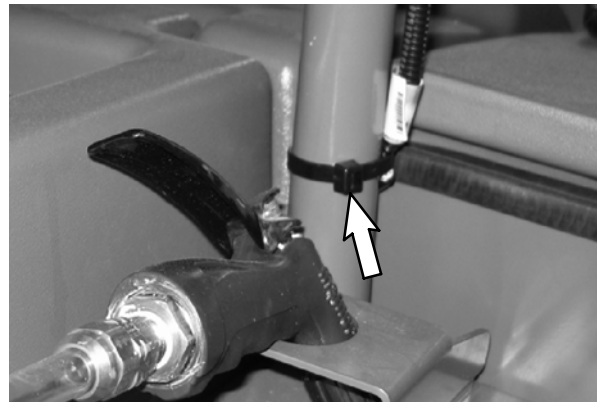

FIG. 8

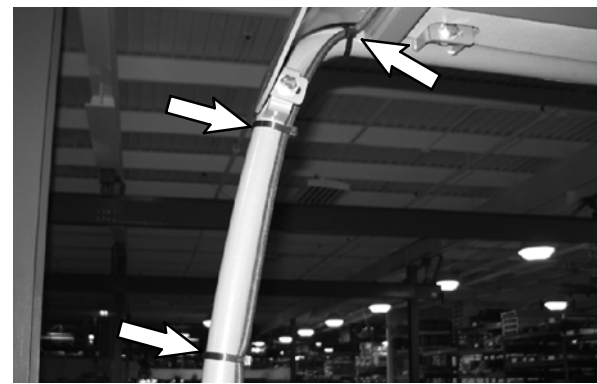

FIG. 9

9. Use two cable ties (8) to secure the warning/overhead harness (5) to the top of the overhead guard. (Fig. 10)
10. Reconnect the negative battery cable to the battery.
11. Start and test the machine to ensure the overhead guard light operates.

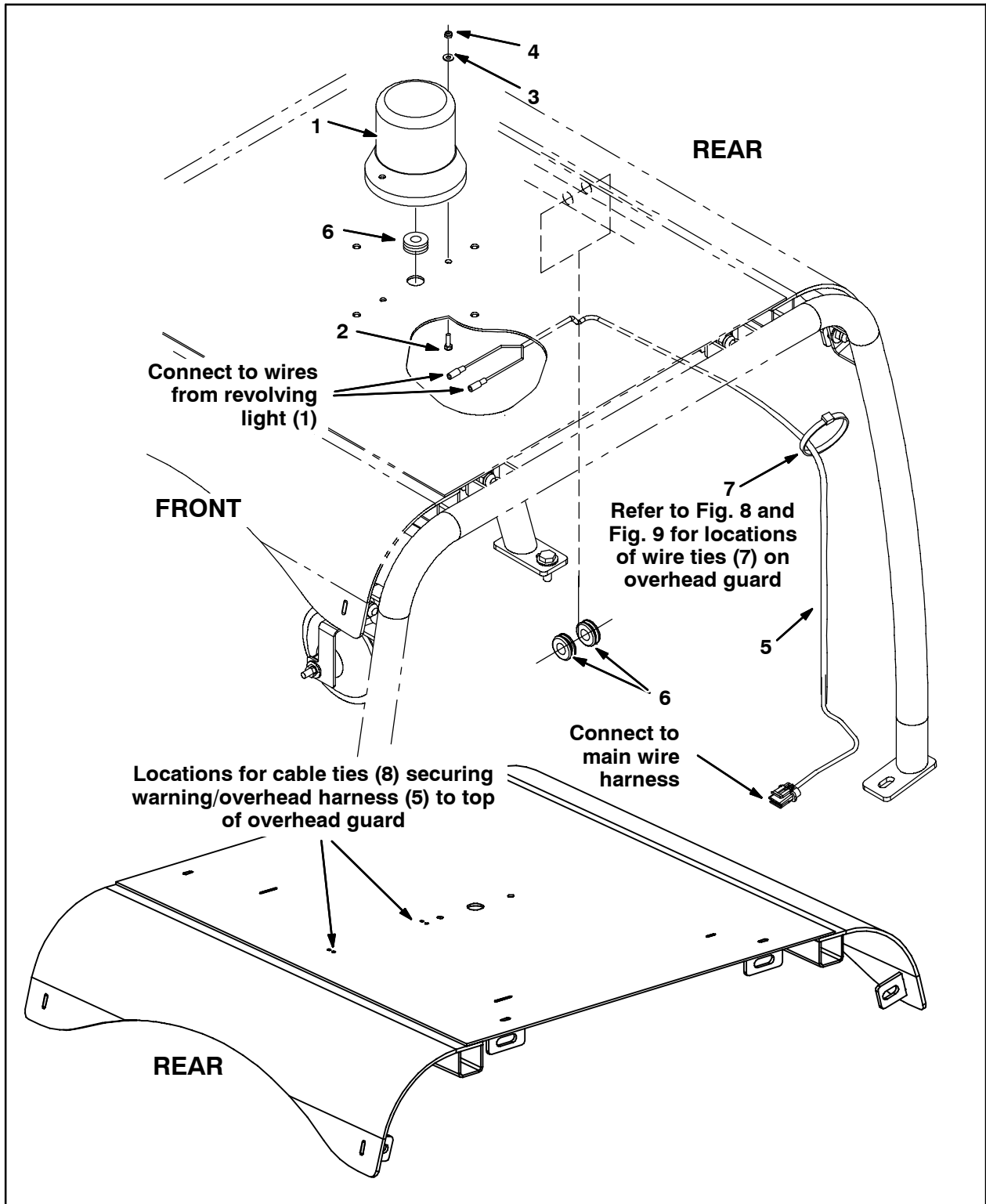

FIG. 10

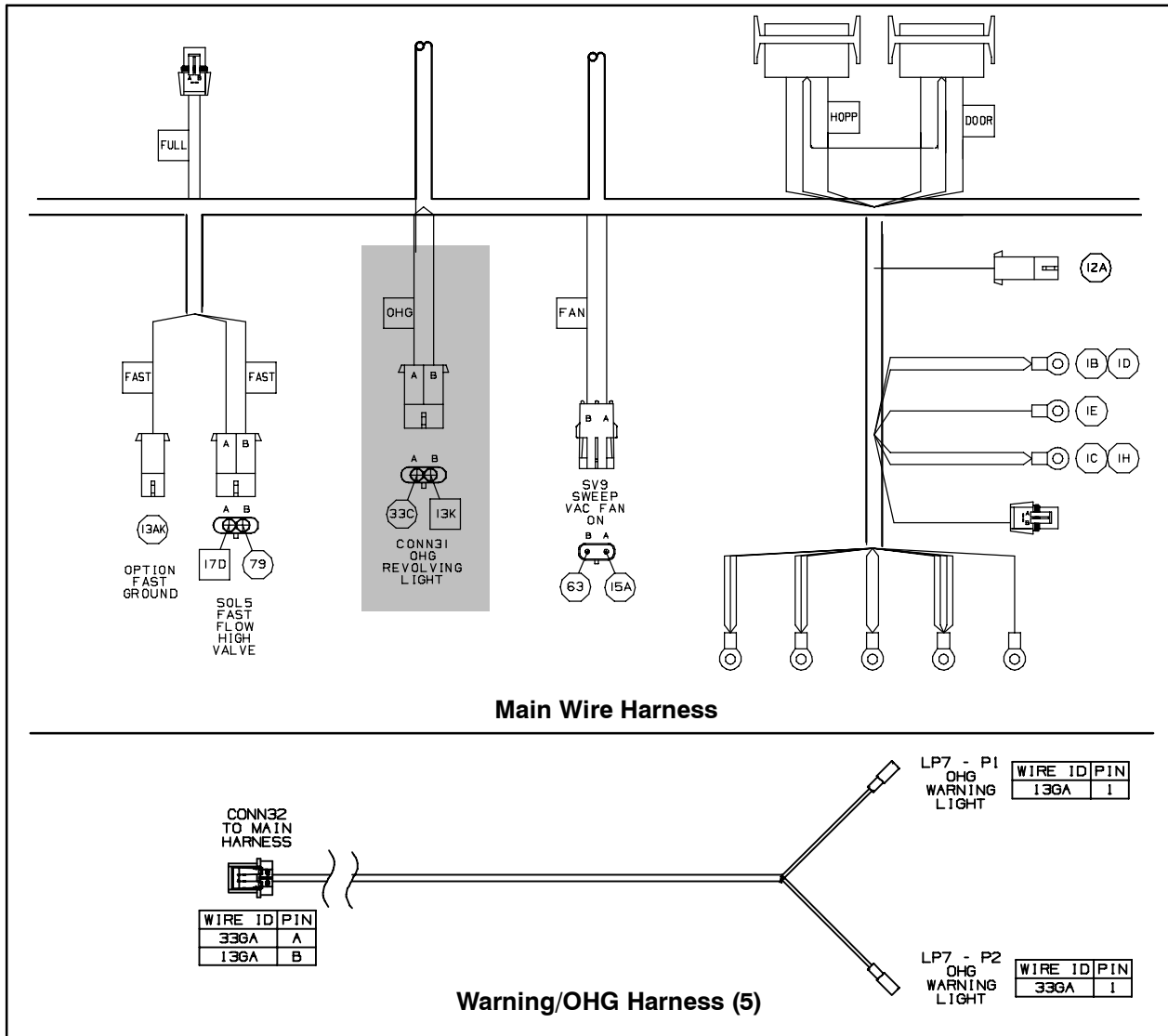

FIG. 11

Bill of Materials for Light Kit, Rev1, W/OHG, CI [M20 and T20]-9001717

Ref.	Tennant Part No.	Description	Qty.	
▽	9001717	Light Kit, Rev1, W/OHG, CI [M20 and T20]	1	
▲	1	1017250	Light, Strobe, Amb, 12-48VDC	1
▲	2	24196	Screw, Pan, M5 X 0.8 X 20, SS	2
▲	3	19066	Washer, Flat, #10	2
▲	4	09739	Nut, Hex, Lock, M5 X 0.80, NL, SS	2
▲	5	1019647	Harness, Warning / OHG [M20]	1
▲	6	10632-17	Grommet, Rbr, 0.50ID, F/0.8H, .12 Matl	4
▲	7	763115	Tie, Cable, 6.0L, 1.25D Max	4
▲	8	49266	Tie, Cable, Nyl, 07.3L .19W 1.8 Max D	2

TENNANT COMPANY
P. O. Box 1452
Minneapolis, MN 55440-1452